

# Block of the Month

September 2008

Schoolhouse

12"

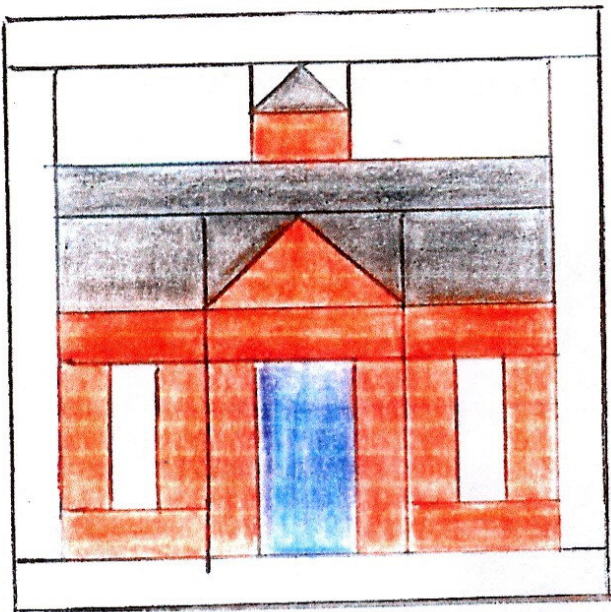

Cutting - all measurements include 1/4" seam

From light blue - sky/border

B cut 2, G cut 2,  
H cut 2, J cut 2

From red - house/chimney

A cut 8, C cut 3,  
F cut 1, K cut 1

From medium blue - door

B cut 1

From yellow - windows

A cut 2

From black - roof/ chimney top

D cut 2, E cut 1,  
G cut 1, I cut 1

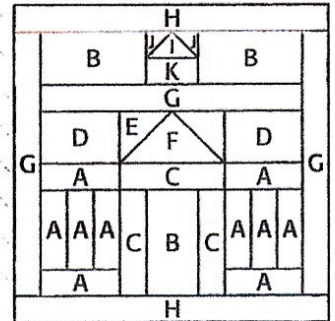

A 1 1/2" x 3 1/2"      D 2 1/2" x 3 1/2"  
B 2 1/2" x 4 1/2"      E 2 7/8"  
C 1 1/2" x 4 1/2"      F 5 1/4"

G 1 1/2" x 10 1/2"      J 1 7/8"  
H 1 1/2" x 12 1/2"      K 1 1/2" x 2 1/2"  
I 3 1/4"

## Sewing

1. Assemble as per diagram:

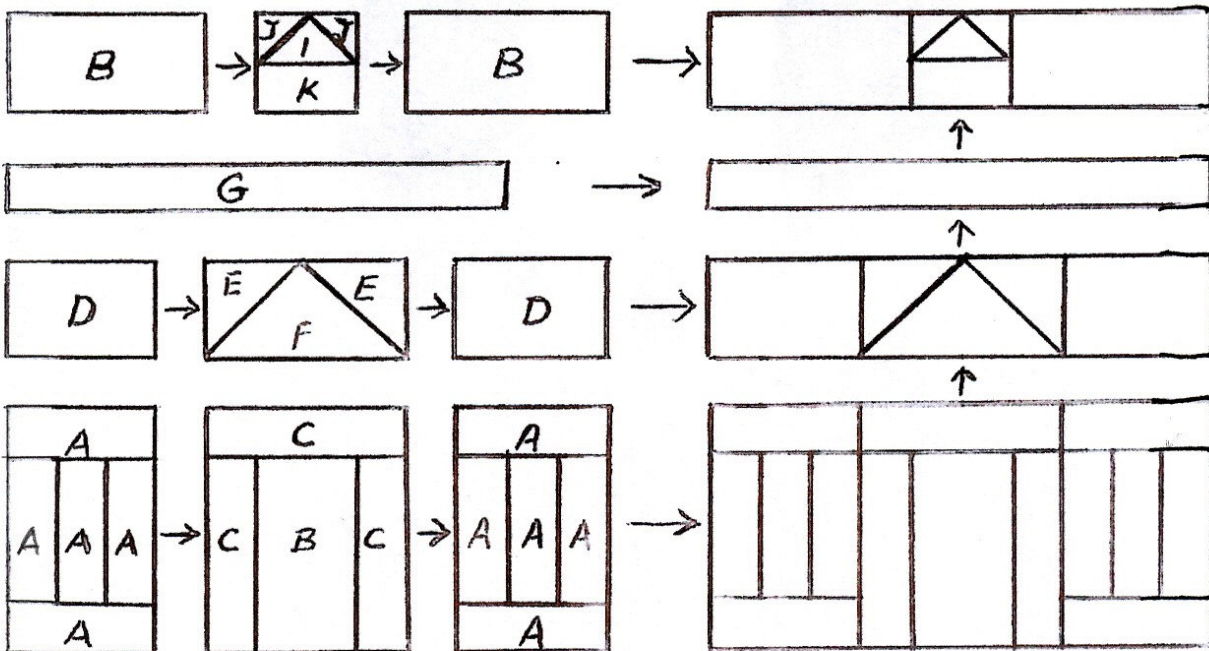

2. Sew 1 light blue G to each side, and sew 1 light blue <sup>H</sup> each to top and bottom.

Questions??? Call Ursula Hohaus-Hawkins 451-0378 or Hildegard Duckworth 723-6556